

APPLICATION FOR CERTIFICATE OF APPROPRIATENESS (COA)

Building address 253 East Church Street

Owner of building Cheryl Dougan and Anthony Viscardi Phone [REDACTED]

Owner's email & mailing address [REDACTED]

Applicant Cheryl Dougan Phone: [REDACTED]

Applicant's email & mailing address [REDACTED]

Street and Number

City

State

Zip Code

**APPLICANT MUST ATTEND MEETING FOR CASE TO BE HEARD.**

**USE THE CHECKLIST ON THE BACK OF THIS APPLICATION TO ENSURE YOUR SUBMISSION IS COMPLETE.**

*Historic & Architectural Review Board – Application form, photographs, and drawings must be submitted 2 weeks prior to the regular scheduled meeting in order to be placed on the agenda for the next meeting.*

*South Bethlehem & Mount Airy Historic Conservation Commission - Application form, photographs, and drawings must be submitted 2 weeks prior to the regular scheduled meeting in order to be placed on the agenda for the next meeting.*

1. **PHOTOGRAPHS** - Photographs of your building and neighboring buildings **must accompany** your application.

2. **TYPE OF WORK PROPOSED** – Check all that apply. Please bring any samples or manufactures specifications for products you will use in this project.

Trim and decorative woodwork

Skylights

Siding and Masonry

Metal work

Roofing, gutter and downspout

Light fixtures

Windows, doors, and associated hardware

Signs

Storm windows and storm doors

Demolition

Shutters and associated hardware

Other Rebuild front porch, retaining original design

Paint (Submit color chips – HARB only)

3. **DRAWINGS OF PROPOSED WORK** – Required drawings **must accompany** your application. Please submit **ONE ORIGINAL AND TEN (10) COPIES OF DRAWINGS, PHOTOGRAPHS, APPLICATION FORM, AND ANY SPECIFICATIONS**

Alteration, renovation, restoration (1/4 or 1/8"=1'0" scale drawings required IF walls or openings altered.)

New addition (1/4" or 1/8"=1'0" scale drawings: elevations, floor plans, site plan)

New building or structure (1/4" or 1/8"=1'0" scale drawings: elevations, floor plans, site plan)

Demolition, removal of building features or building (1/4" or 1/8"=1'0" scale drawings: elevation of remaining site and site plan)

A scale drawing, with an elevation view, is required for all sign submittals

4. **DESCRIBE PROJECT** – Describe any work checked in #2 and #3 above. Attach additional sheets as needed.

Rebuild front porch, retaining original design, decorative trim, and paint colors: Remove rotted wood columns, decking and steps. Replace with composite columns with same design profile, paint white. Replace porch decking and stairs with paint grade tongue and groove mahogany or paintable Aeratis composite. (Approved for historic restoration - samples provided) Replace failed concrete drain swale, correct elevation to direct drainage away from foundation.

5. **APPLICANT'S SIGNATURE**

*Cheryl Dougan Anthony Viscardi*

DATE: May 3, 2019



**253 East Church Street  
Front Porch Rebuild Project**





**Column to be replaced with  
paintable composite column  
of same design**



**Remove and replace service  
walkway in front  
(approximately 13' x 2.5' and  
concrete swale on left side of**

# AERATIS



## Aeratis Heritage



An Aeratis Heritage installation. [Click here for the Aeratis photo gallery.](#)

Aeratis Heritage is a true double-sided tongue and groove porch plank that comes in three pre-finished colors, Battleship Gray, Weathered Wood and Vintage Slate. These colored boards are made with slight color variation along with subtle, random streaking to match the richness and depth of natural wood. Heritage, like all the other Aeratis products, can be painted or stained any color, any time in the future, by following the steps within the Traditions paint instructions.

The Heritage line of products are ADA slip compliant and carry a Class "B" fire rating (more flame resistant than any other competitors product). This double sided board offers a finished ceiling look from the under side of a porch floor that is visible from underneath.

Aeratis Heritage T&G porch flooring board dimensions are 3-1/8" x 7/8" and are available in 10', 12' and 16' lengths. As seen above from left to right: Battleship Gray, Weathered Wood and Redwood. The Aeratis products have the

appearance of wood and natural color variation.

### Aeratis Heritage T&G Porch Flooring Dimensions

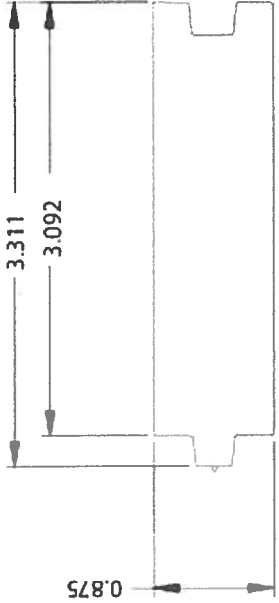

**Lengths:** 10', 12', or 16'

**Width:** 3-1/8" (3.092)

**Thickness:** 7/8"

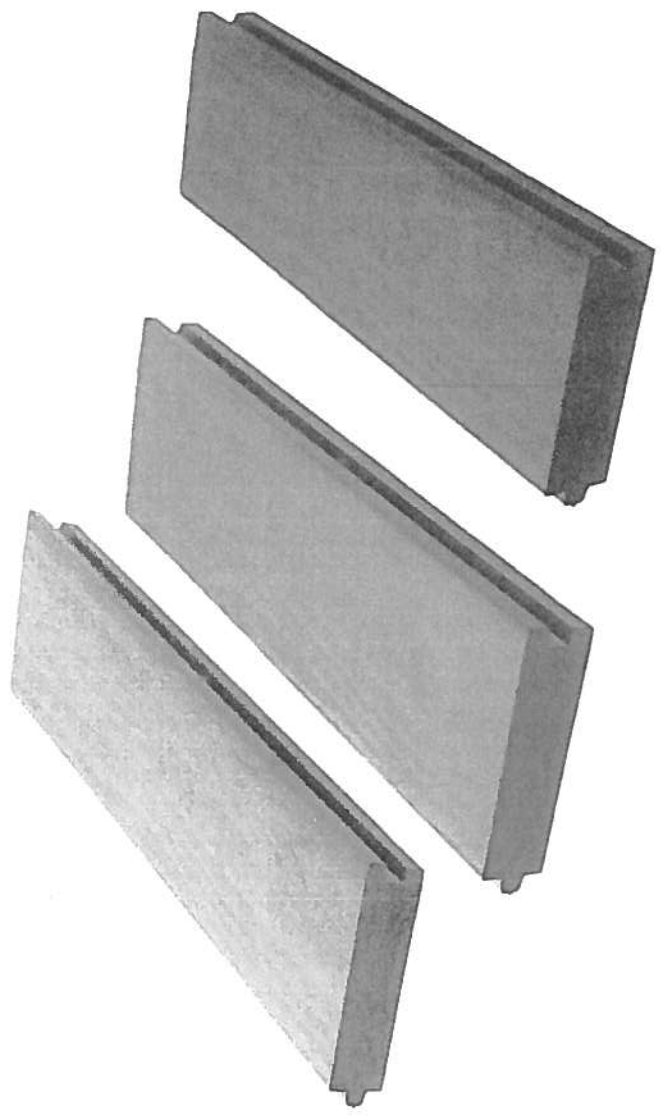

Aeratis Battleship Gray, Weathered Wood and Vintage Slate

Where To Buy